

SECTION B-B

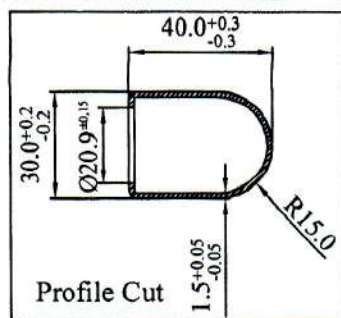

SECTION C-C

L	I	H
450	400	42
500	450	45
550	500	46
600	550	46

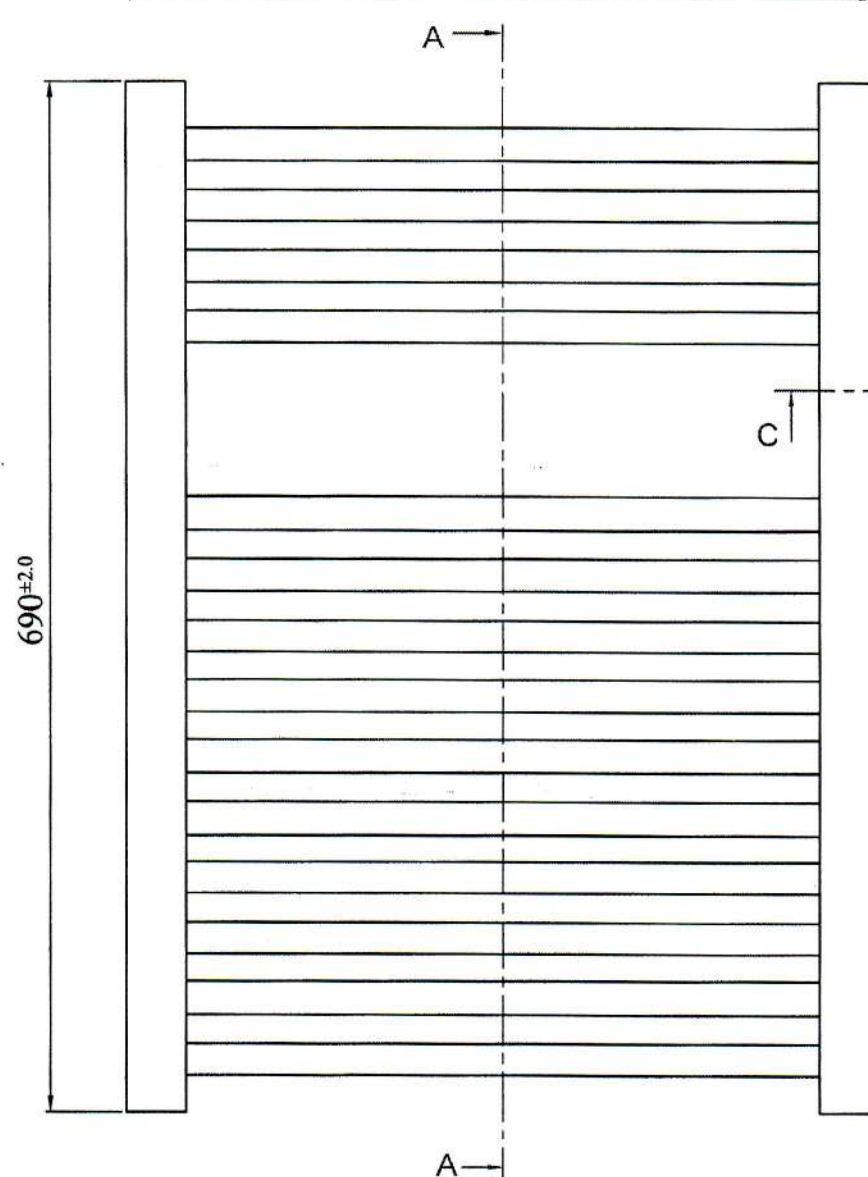
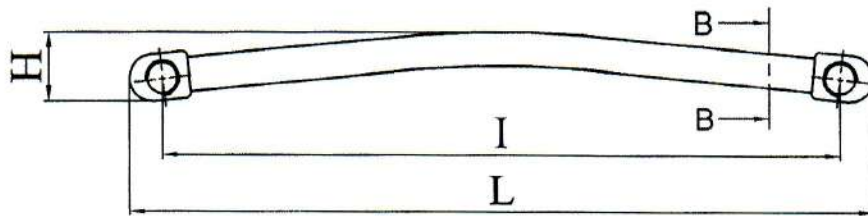

10 + 4 = 14 Tubes

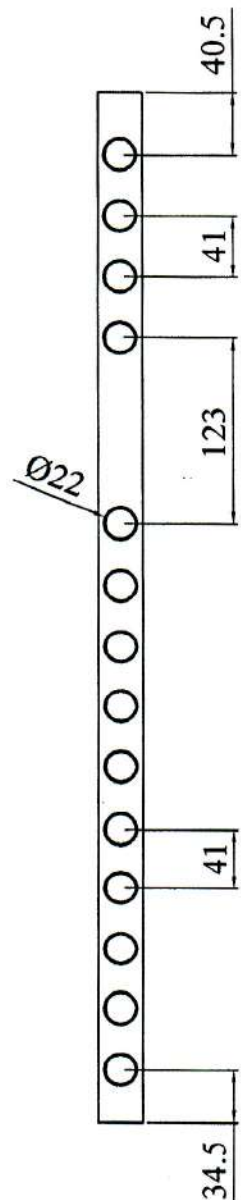

SECTION A-A

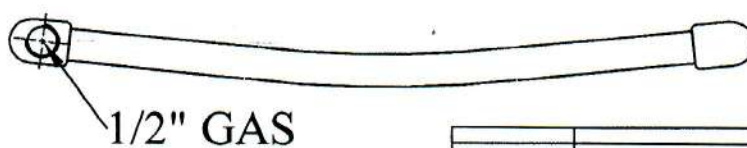

			Designer: S.TORR
Date:	Modification:		Date: 30.09.2010
Scale:	Scale Tolerance: 40.5 mm	Code: SANREDO CV h. 690	
	Material: Steel	Description: SANREDO curvo - h. 690 SANREDO curved - h. 690	

lazzarini
ITALIANA

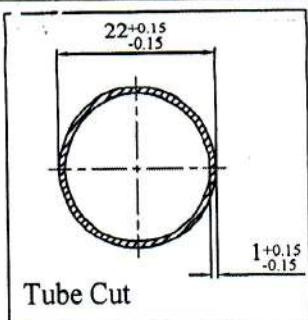

SECTION B-B

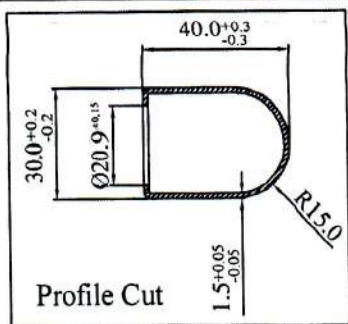

SECTION C-C

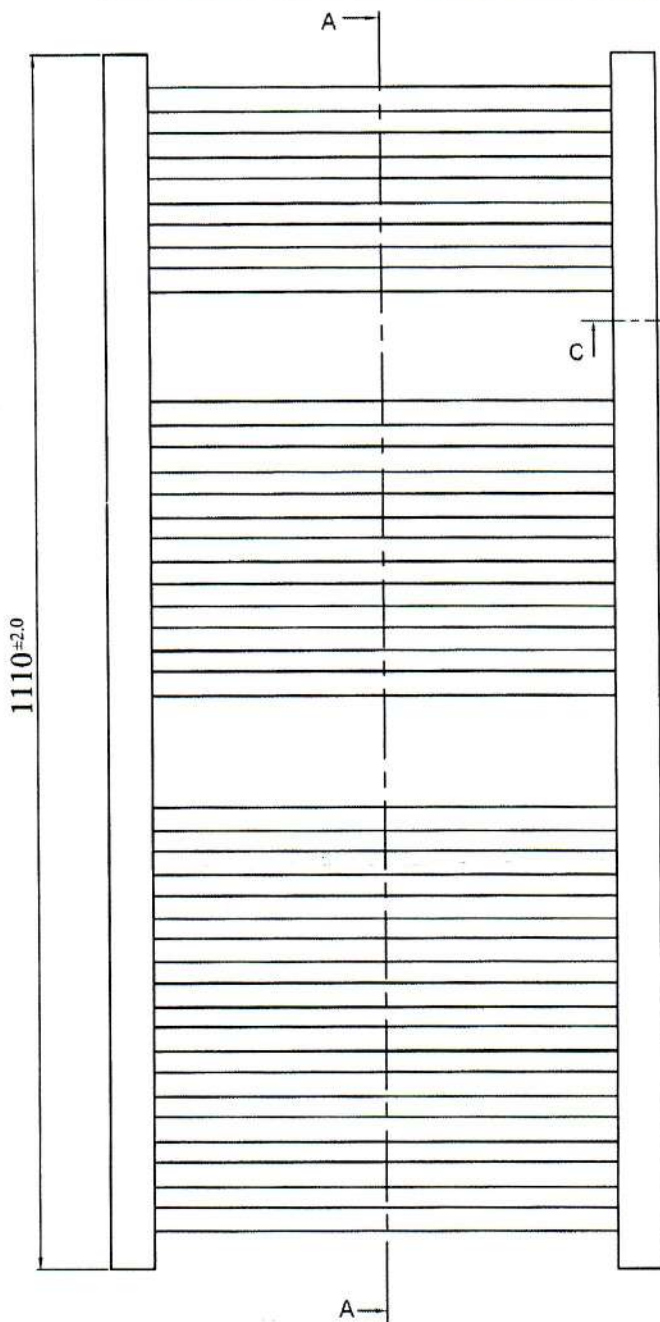
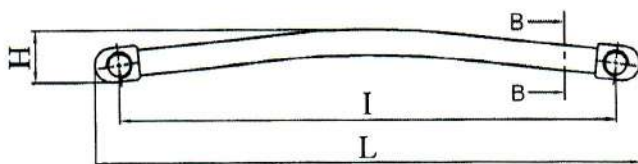

10 + 7 + 5 = 22 Tubes



1/2" GAS

L	I	H
450	400	42
500	450	45
550	500	46
600	550	46

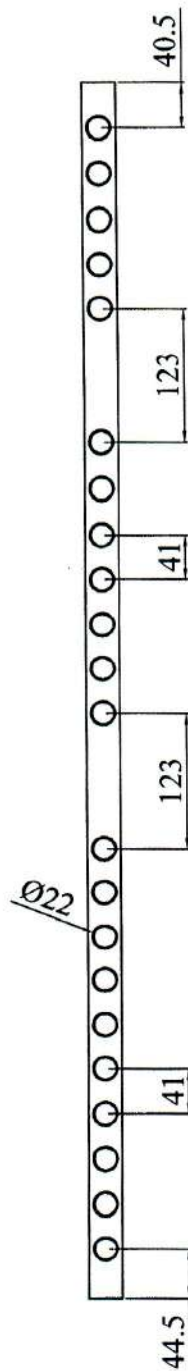

SECTION A-A

Date			Design: S.TSP
Scale			Date: 30.09.2010
	Modifications:	Code: SANREMO CV h 1110	
	Dim. Tolerances:	Description: SANREMO curvo - h 1110 SANREMO curvad - h 1110	
	±0.5 mm		
	Material:	Steel	

lazzarini
S.p.A.

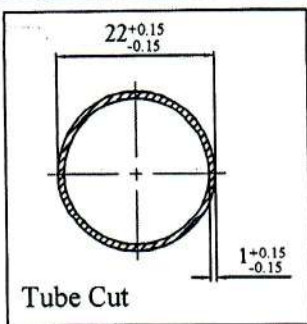

SECTION B-B

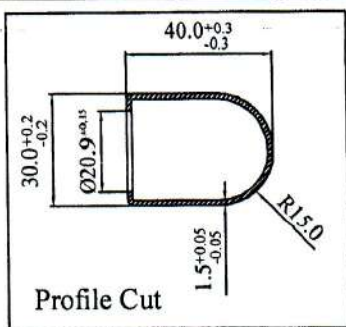

SECTION C-C

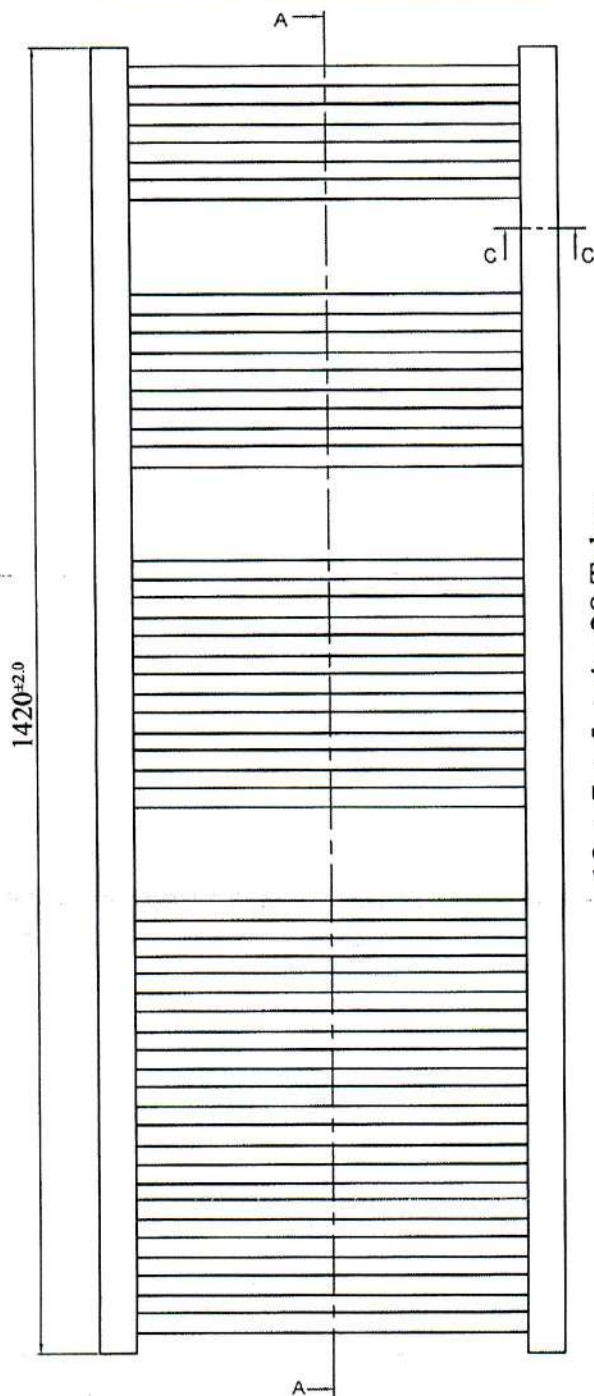
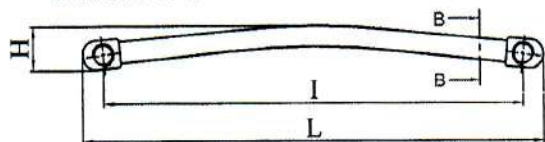

12 + 7 + 5 + 4 = 28 Tubes

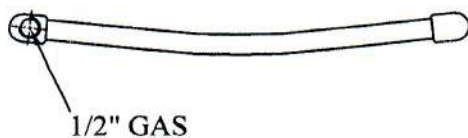

L	I	H
450	400	42
500	450	45
550	500	46
600	550	46

Verificare a catalogo le larghezze disponibili
See catalogue for available widths

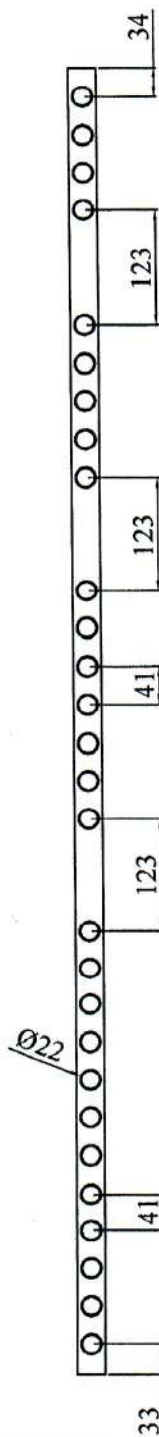

SECTION A-A

			Designer: S. TIZZI
			Date: 30.09.2010
Date:	Modification:		
Scale:	Gen. Tollerances: ±0.3 mm	Code: SANREMO CV h 1420	
	Material: Steel	Description: SANREMO curvo - h 1420 SANREMO curvo - h 1420	

lazzarini
FIDELITY

L	I	H
450	400	42
500	450	45
550	500	46
600	550	46

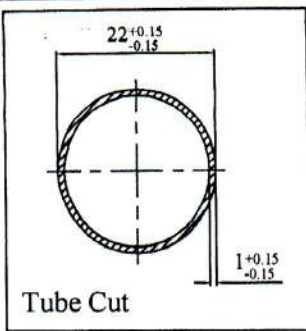

SECTION B-B

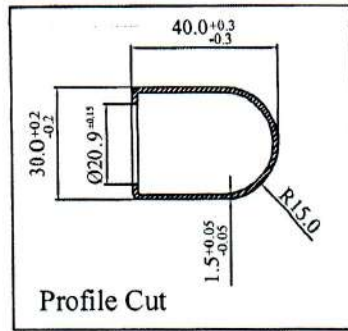

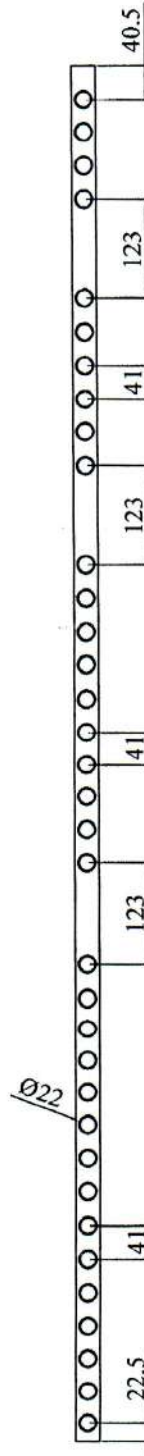
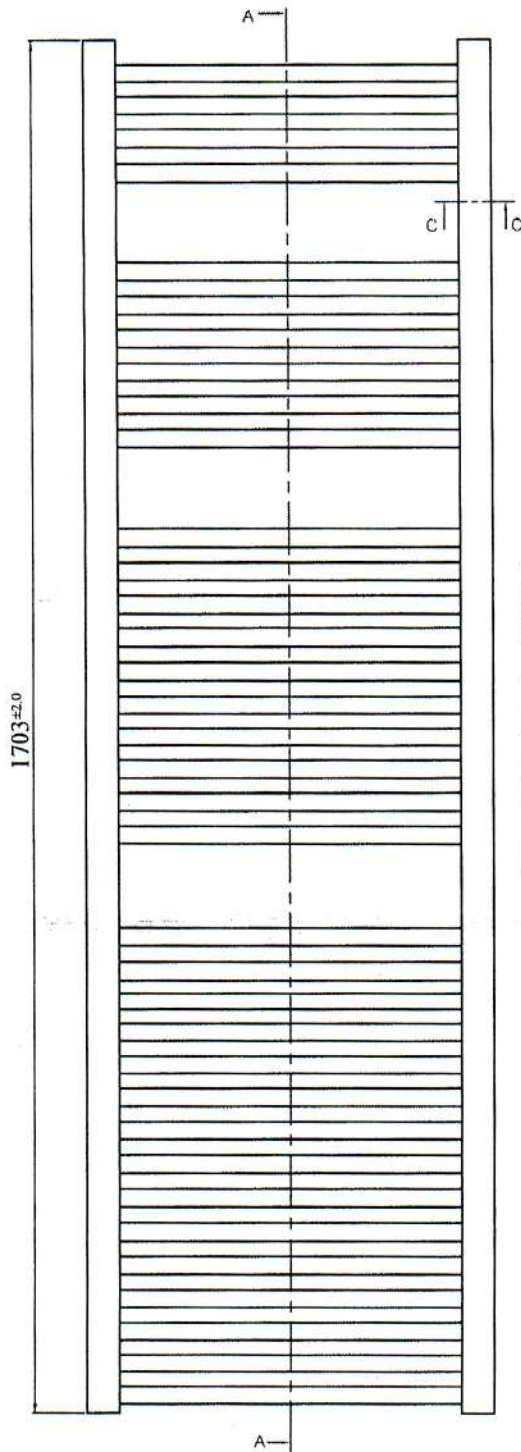
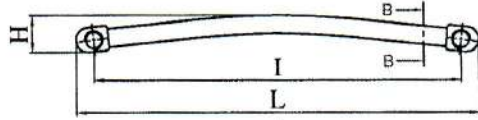

SECTION C-C

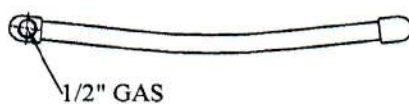

SECTION A-A

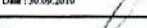

			Designer : S.TYPI
Date	Modification		Date : 30.09.2010
Scale:	Gen. Tolerances : ±0.5 mm	Code: SANREMO CV h 1703	
Material: Steel		Description: SANREMO curvo - h 1703 SANREMO curved - h 1703	
			

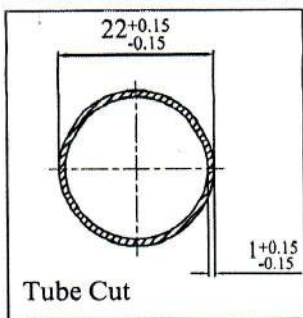

SECTION B-B

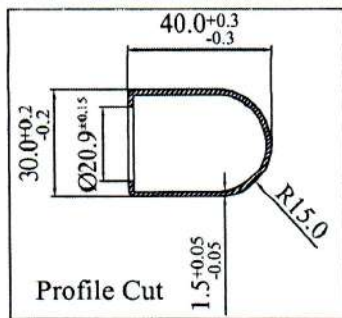

SECTION C-C

L	I
450	400
500	450
550	500
600	550

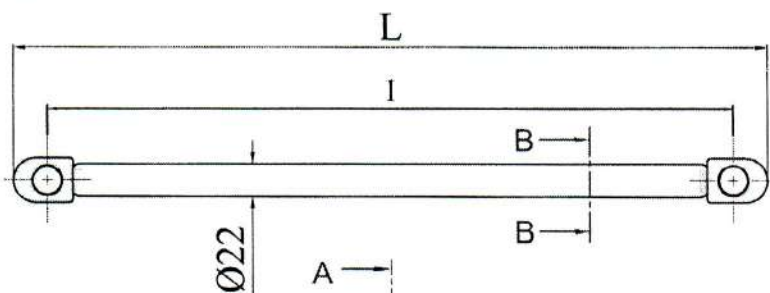

690±2.0

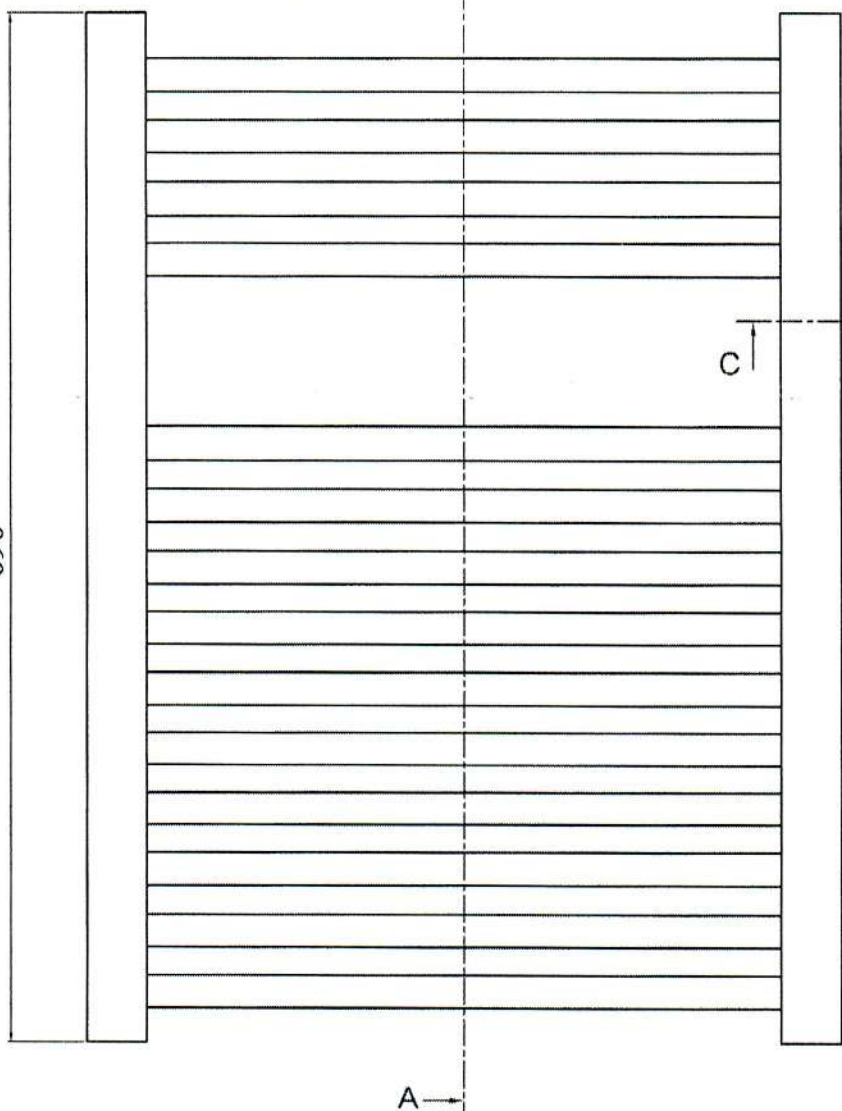

10 + 4 = 14 Tubes

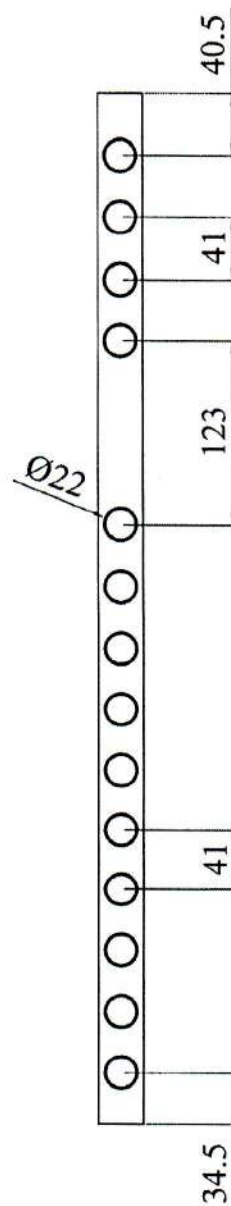

SECTION A-A

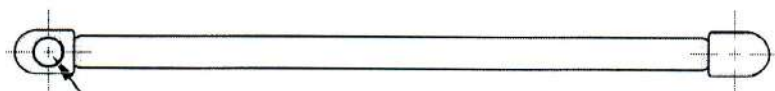

1/2" GAS

		Designer: S. Tepe
Date:	Modification:	Issue date: 30-09-2013
Scale:	Tolerances ± 0.5 mm	Drawing code: SANREMO DR h 690
	Material: steel	Description: SANREMO dritto - h 690 SANREMO straight - h 690
		lazzarini

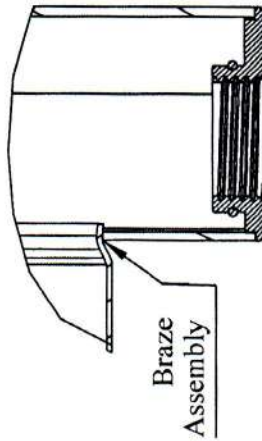
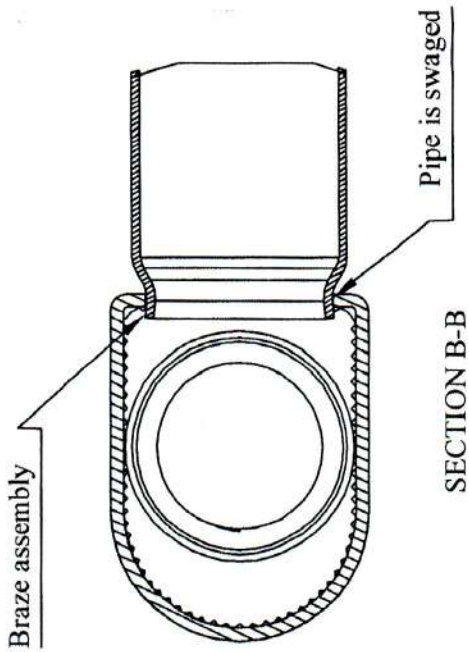
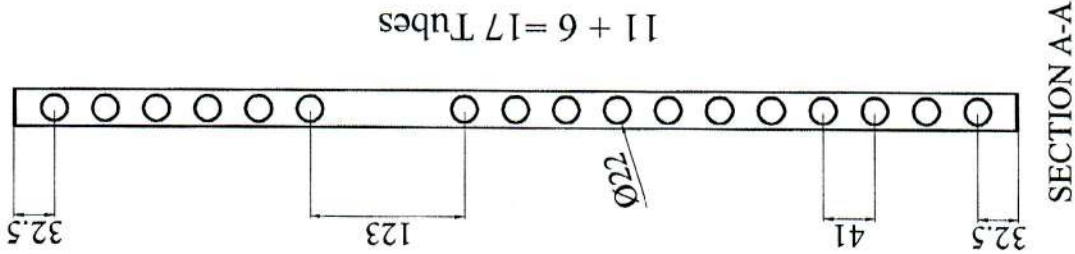
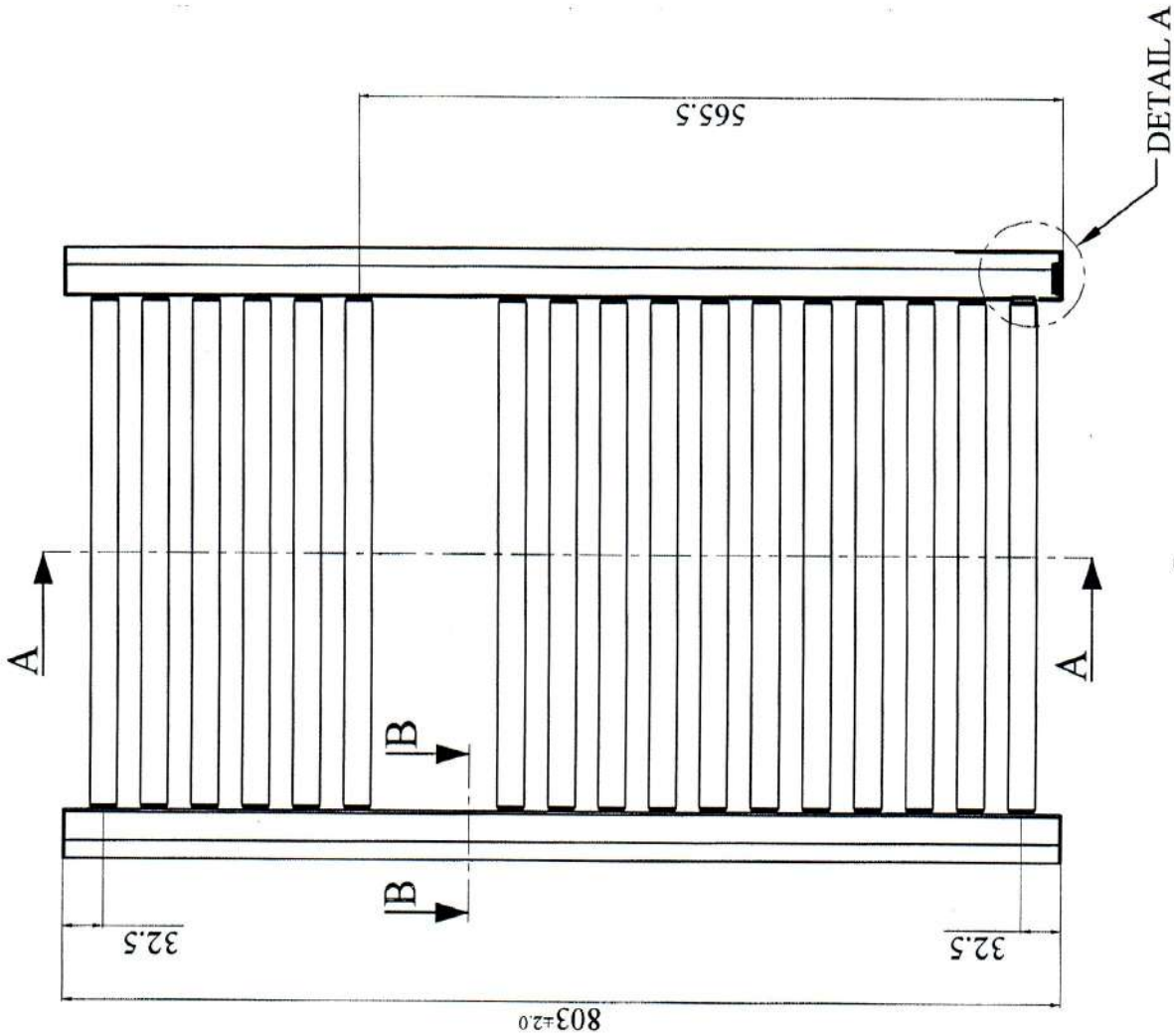

DETAIL A

L	I
400	355,5
450	405,5
500	455,5
550	505,5
600	555,5
750	605,5

Designer: STEPE	Date: 13.04.2010
Code: SANREMO DR 3.803	Description: SANREMO Dr 3.803
Modification:	Scale: 40.5 mm
Gen. Tolerances:	Material:

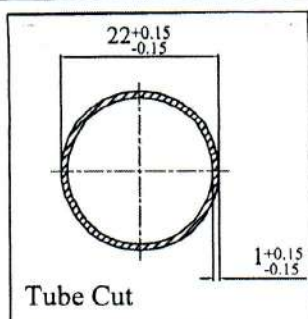

SECTION B-B

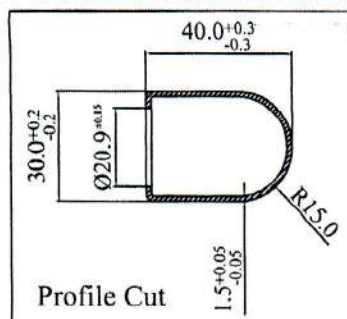

SECTION C-C

L	I
450	400
500	450
550	500
600	550

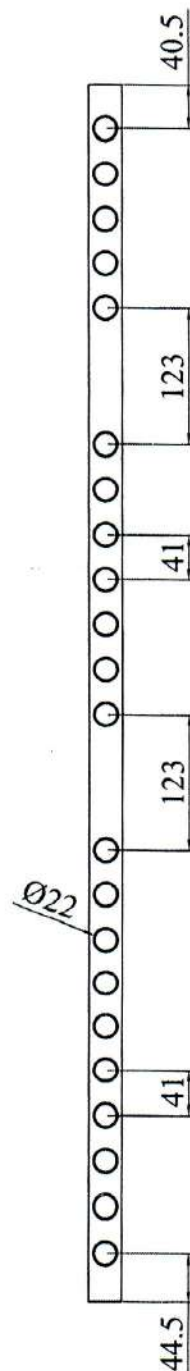
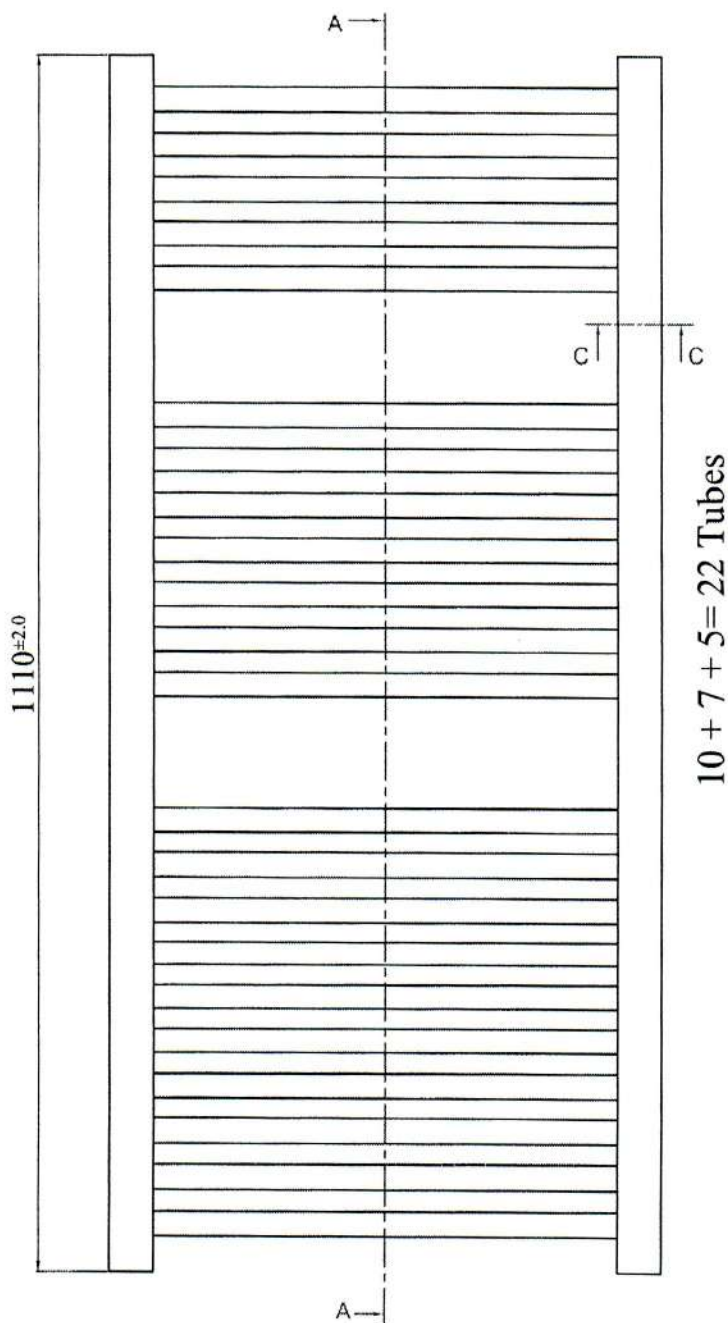

SECTION A-A

Date:	Modification:	Drawing code: SANREMO DR h 1110	Designer: S. Tepe
Scale:	Tolerances $\pm 0,5$ mm	Description: SANREMO dritto - h 1110	Issue date: 30-09-2010
	Material: steel	SANREMO straight - h 1110	lazzarini

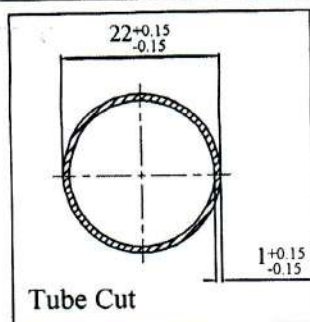

SECTION B-B

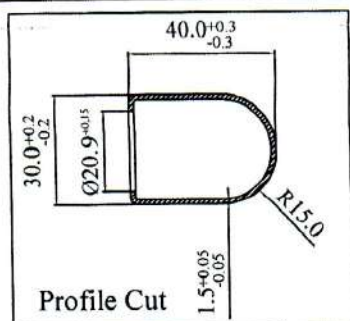

SECTION C-C

L	I
400	350
450	400
500	450
550	500
600	550
750	700

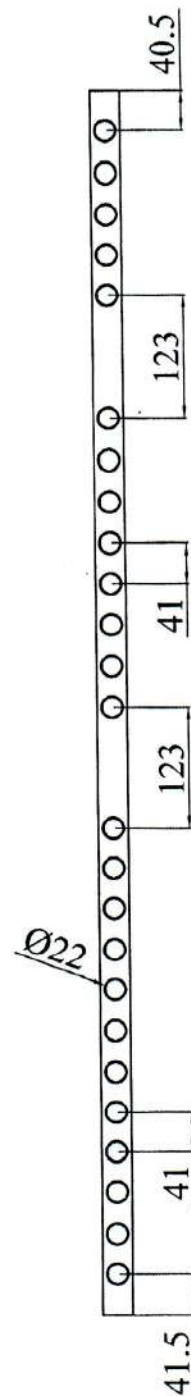
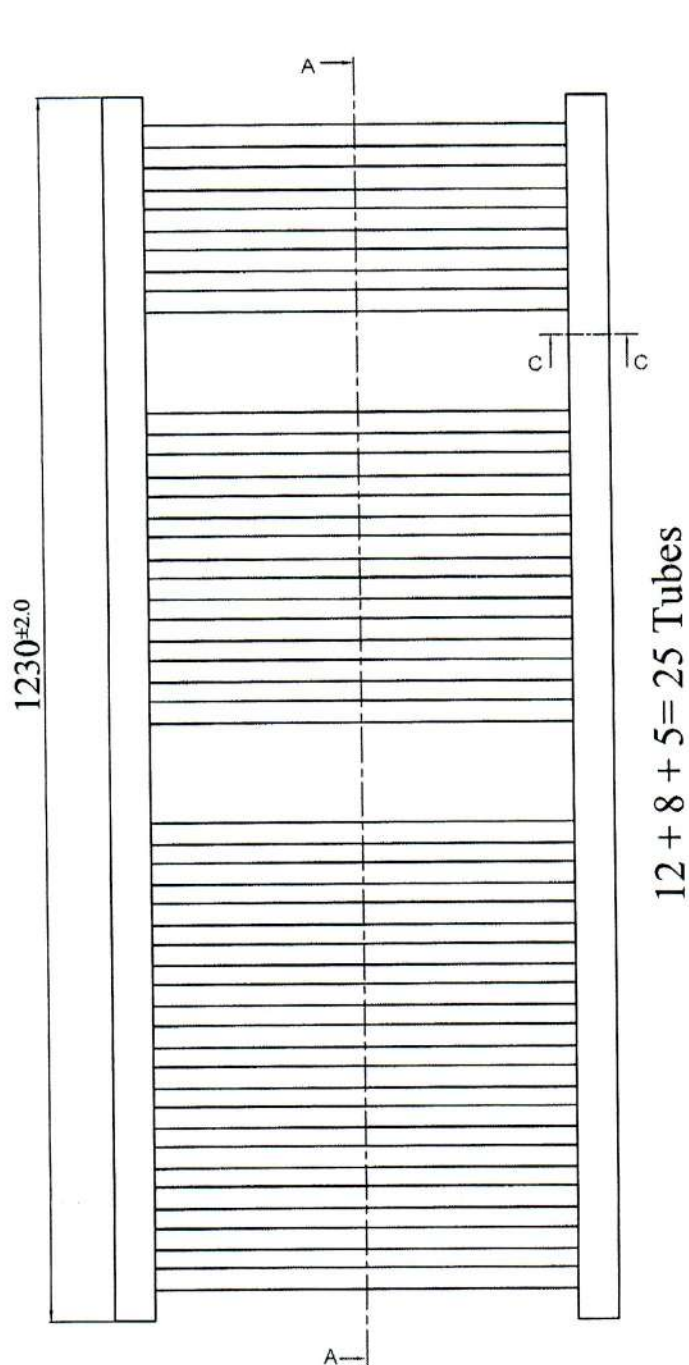

SECTION A-A

Date		Modification	Designer: S. TEPE
Scale:	Ømm: Tolerances: ±0.5 mm	Code: SANREMO DR h 1230	Date: 30.09.2010
	Material: Steel	Description: SANREMO diretto - h 1230 SANREMO straight - h 1230	

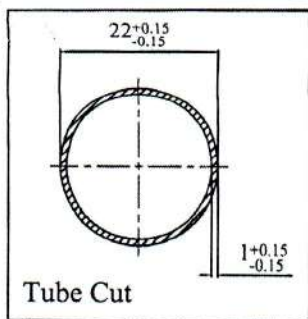

SECTION B-B

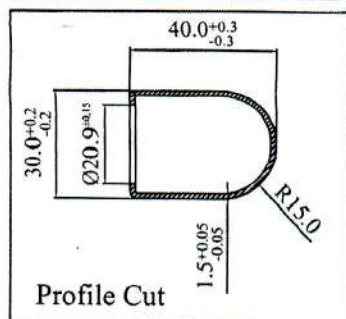

SECTION C-C

L	I
400	350
450	400
500	450
550	500
600	550
750	700

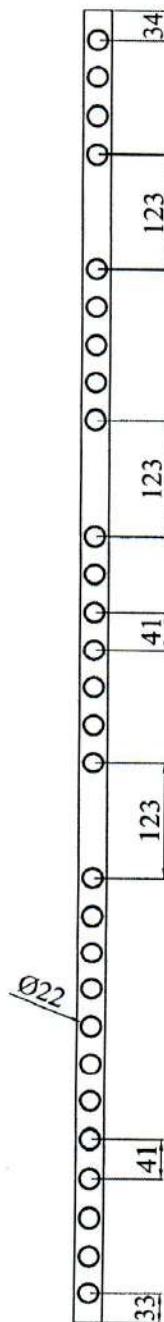
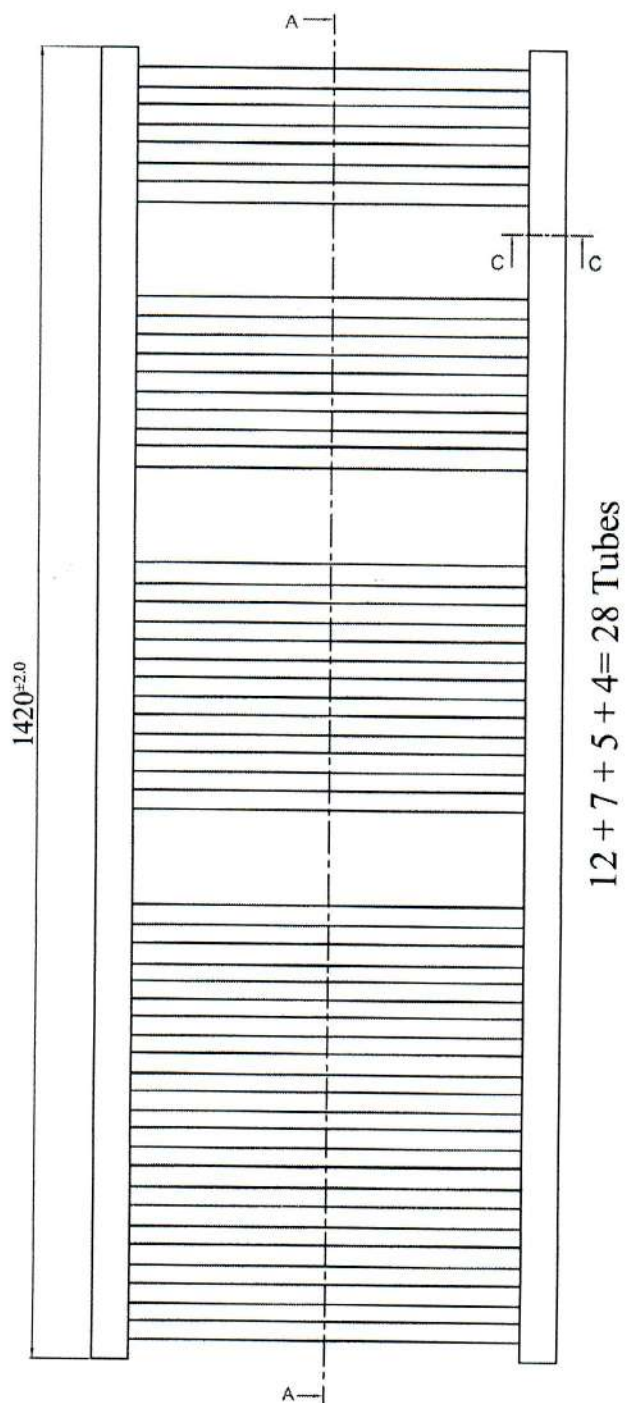

SECTION A-A



			Designer: S. Tope
Date:	Modification:	Issue date: 30-09-2010	
Scale:	Tolerances ± 0.5 mm	Drawing code: SANREMO DR h 1420	
Material: steel		Description: SANREMO dritto - h 1420 SANREMO straight - h 1420	



L	I
450	400
500	450
550	500
600	550
750	700

Verificare a catalogo le larghezze disponibili
See catalogue for available widths



		Designer : S TEPÉ	
Date	Modification		Date : 30.09.2010
Scale :	Cieme.Tolerances :	Code: SANREMO DR h 1703	
	40,5 mm	Description: SANREMO dritto - h 1703 SANREMO straight - h 1703	
	Material :		 lazzarini INDUSTRIE
	Steel		