

## BALL VALVES

0594EN 02/2021

VALVE FOR WATER FOR HEATING/COOLING SYSTEMS  
NOT DANGEROUS GAS AND LIQUID HYDROCARBONS  
STANDARD PORT - R254D SERIES



**GIACOMINI**  
WATER E-MOTION

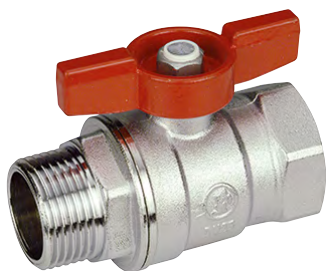

R254D

### Description

Ball valve, with female-male threaded connections.  
Standard port.

### Versions and product codes

Product code	Connections	Finishing	Handle type	Handle color
R254X001	G 1/4" F x R 1/4"	Chrome plated brass	T-handle	Red
R254X002	G 3/8" F x R 3/8"	Chrome plated brass	T-handle	Red
R254X003	G 1/2" F x R 1/2"	Chrome plated brass	T-handle	Red
R254X004	G 3/4" F x R 3/4"	Chrome plated brass	T-handle	Red
R254X005	G 1" F x R 1"	Chrome plated brass	T-handle	Red
R254X006	G 1-1/4" F x R 1-1/4"	Chrome plated brass	T-handle	Red
R254ZX002	Rc 3/8" x R 3/8"	Chrome plated brass	T-handle	Red
R254ZX003	Rc 1/2" x R 1/2"	Chrome plated brass	T-handle	Red
R254ZX004	Rc 3/4" x R 3/4"	Chrome plated brass	T-handle	Red
R254ZX005	Rc 1" x R 1"	Chrome plated brass	T-handle	Red
R254ZX006	Rc 1-1/4" x R 1-1/4"	Chrome plated brass	T-handle	Red

### Technical data

#### Main features and materials

- Suitable for water for heating/cooling systems, not dangerous gas and liquid hydrocarbons\*
- Standard port
- Valve made of UNI EN 12165 CW617N chrome plated brass
- Stem with double O-Ring
- Nut with anti-corrosion coating, with guarantee seal and hologram
- Aluminium T-handle, red painted

#### Field of applications

- Min. working temperature: -20 °C with 50 % glycol solutions
- Max. working temperature with dry saturated steam: 185 °C with 1,05 MPa (10,5 bar)
- Max. working pressure at 20 °C with water and not dangerous gas: 4,2 MPa (42 bar) for 1/4", 3/8", 1/2", 3/4" 3,5 MPa (35 bar) for 1", 1-1/4"
- Temperature range with liquid hydrocarbons\*: -20÷60 °C
- Max. working pressure at 20 °C with liquid hydrocarbons\*: 1,2 MPa (12 bar)

\* Please consult Giacomini technical support, to check the compatibility of the product with the specific hydrocarbon.

### Dimensions and Kv

Product code	DN	A [mm]	I [mm]	B [mm]	J [mm]	C [mm]	H [mm]	Kv
R254X001	8	51	21	35	10	40	wr.17	6,6
R254X002	10	55	22	46	14	63	wr.21	6,7
R254X003	14	64	27	51	15	63	wr.25	10,2
R254X004	18	76	31	60	18	73	wr.32	18,5
R254X005	22	89	38	69	23	73	wr.39	36,3
R254X006	28	100	42	78	28	73	wr.48	73,5
R254ZX002	10	55	22	46	14	63	wr.21	6,7
R254ZX003	14	64	27	51	15	63	wr.25	10,2
R254ZX004	18	76	31	60	18	73	wr.32	18,5
R254ZX005	22	89	38	69	23	73	wr.39	36,3
R254ZX006	28	100	42	78	28	73	wr.48	73,5

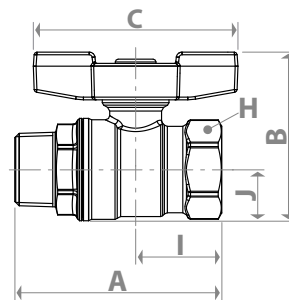

### Product specifications

#### R254D - Red T-handle

Ball valve, with female-male threaded connections. Suitable for water for heating/cooling systems, not dangerous gas and liquid hydrocarbons. Valve made of UNI EN 12165 CW617N chrome plated brass. Standard port. Aluminium T-handle, red painted. Stem with double O-Ring. Nut with anti-corrosion coating, with guarantee seal and hologram. Min. working temperature: -20 °C with 50 % glycol solutions. Max. working temperature with dry saturated steam: 185 °C with 1,05 MPa (10,5 bar). Max. working pressure at 20 °C with water and not dangerous gas: 4,2 MPa (42 bar) for 1/4", 3/8", 1/2", 3/4"; 3,5 MPa (35 bar) for 1", 1-1/4". Temperature range with liquid hydrocarbons: -20÷60 °C. Max. working pressure at 20 °C with liquid hydrocarbons: 1,2 MPa (12 bar).

## BALL VALVES

0594EN 02/2021

VALVE FOR DANGEROUS GAS AND LIQUID HYDROCARBONS  
STANDARD PORT - R254D SERIES



**GIACOMINI**  
WATER E-MOTION



R254D

### Description

Ball valve, with female-male threaded connections.  
Standard port.

### Versions and product codes

Product code	Connections	Finishing	Handle type	Handle color
R254X021	G 1/4" F x R 1/4"	Chrome plated brass	T-handle	Yellow
R254X022	G 3/8" F x R 3/8"	Chrome plated brass	T-handle	Yellow
R254X023	G 1/2" F x R 1/2"	Chrome plated brass	T-handle	Yellow
R254X024	G 3/4" F x R 3/4"	Chrome plated brass	T-handle	Yellow
R254X025	G 1" F x R 1"	Chrome plated brass	T-handle	Yellow
R254X026	G 1-1/4" F x R 1-1/4"	Chrome plated brass	T-handle	Yellow

### Technical data

#### Main features and materials

- Suitable for dangerous gas and liquid hydrocarbons\*
- Standard port
- Valve made of UNI EN 12165 CW617N chrome plated brass
- Stem with double O-Ring
- Nut with anti-corrosion coating, with guarantee seal and hologram
- Aluminium T-handle, yellow painted

#### Field of applications

- Temperature range: -20÷60 °C
- Max. working pressure at 20 °C with liquid hydrocarbons\*: 1,2 MPa (12 bar)
- Max. operating pressure (MOP) with gas: 0,5 MPa (5 bar)

\* Please consult Giacomini technical support, to check the compatibility of the product with the specific hydrocarbon.

### Dimensions

Product code	DN	A [mm]	I [mm]	B [mm]	J [mm]	C [mm]	H [mm]
R254X021	8	51	21	35	10	40	wr.17
R254X022	10	55	22	46	14	63	wr.21
R254X023	14	64	27	51	15	63	wr.25
R254X024	18	76	31	60	18	73	wr.32
R254X025	22	89	38	69	23	73	wr.39
R254X026	28	100	42	78	28	73	wr.48

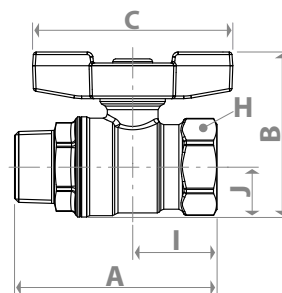

### Product specifications

#### R254D - Yellow T-handle

Ball valve, with female-male threaded connections. Suitable for dangerous gas and liquid hydrocarbons. Valve made of UNI EN 12165 CW617N chrome plated brass. Standard port. Aluminium T-handle, yellow painted. Stem with double O-Ring. Nut with anti-corrosion coating, with guarantee seal and hologram. Temperature range: -20÷60 °C. Max. working pressure at 20 °C with liquid hydrocarbons: 1,2 MPa (12 bar). Max. operating pressure (MOP) with gas: 0,5 MPa (5 bar).

#### Additional information

For more information, go to [www.giacomini.com](http://www.giacomini.com) or contact our technical assistance service: ☎ +39 0322 923372 📠 +39 0322 923255 ✉ [consulenza.prodotti@giacomini.com](mailto:consulenza.prodotti@giacomini.com)  
This document provides only general indications. Giacomini S.p.A. may change at any time, without notice and for technical or commercial reasons, the items included herewith.  
The information included in this technical sheet do not exempt the user from strictly complying with the rules and good practice standards in force.  
Giacomini S.p.A. Via per Alzo, 39 - 28017 San Maurizio d'Opaglio (NO) Italy