

[illegible]

This diagram illustrates the final step of the installation. It shows the glass door, which has a black frame and a silver handle, being placed into the cabinet's frame. The door is shown in two positions: first, being lowered into the frame, and second, fully seated and closed. The cabinet is shown in a light gray color, and the floor is indicated by a light gray line.

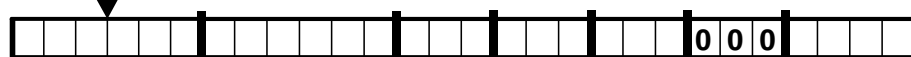
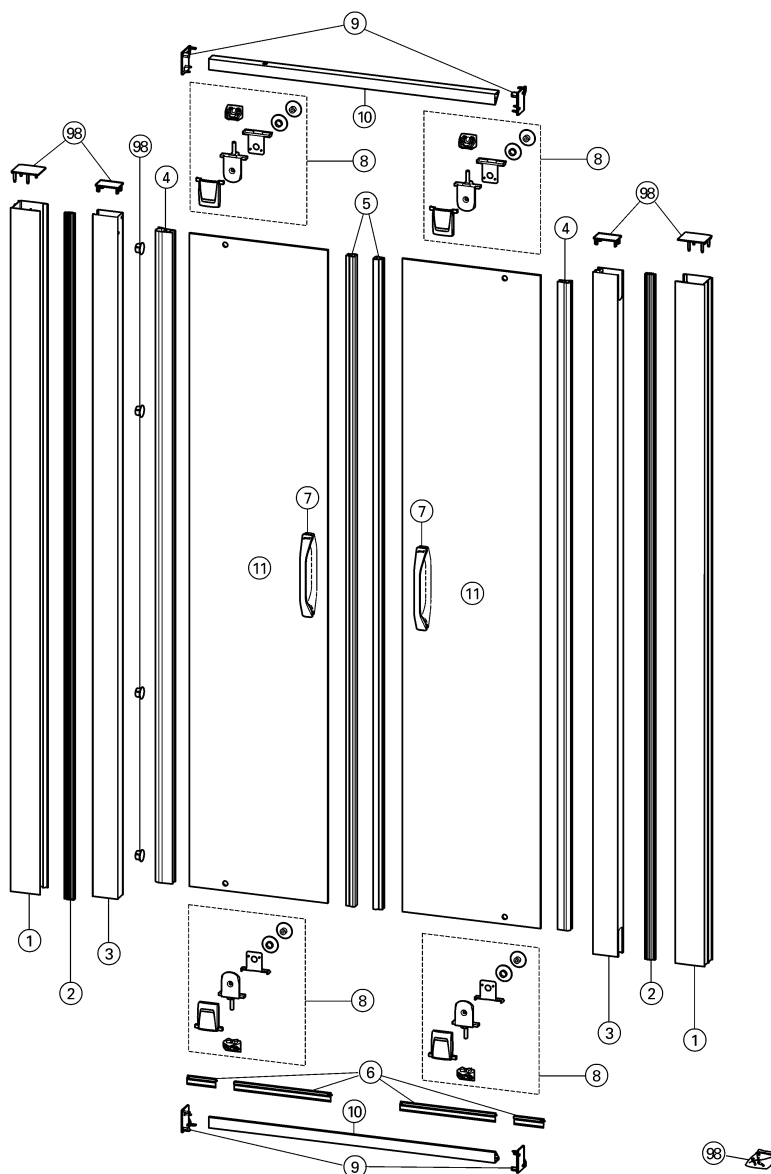

Identity number
XXXXXX . XXX . XXX

XXX . 000 . XXXX

Made in Germany

